



Thermal & Sound Batts

High Performance Residential Insulation



Product Description

Tontine Thermal & Sound Batts are manufactured using thermally bonded polyester fibres, with a minimum of 80% recycled fibres. As well as being manufactured to comply with AS/NZS 4859.1, Tontine Thermal & Sound Batts provide both thermal and acoustic performance. They are non-toxic and user-friendly, requiring no specific protective clothing for installation. Tontine Thermal & Sound Batts will not corrode or deteriorate over time. The products are generally white in colour. For more information on physical properties and material safety data please refer to the Tontine Bonded Polyester Products Material Safety Data Sheet.

Applications

Tontine Thermal & Sound Batts have been designed to provide a safe and efficient thermal and acoustic insulation for the Australian building market. Tontine Thermal & Sound Batts are specially designed for use in both internal and external walls and correctly installed will improve energy efficiency, reduce greenhouse gas emissions and improve room-to-room privacy by reducing sound transmission.

Standard R-Values, Sizes and Packaging (to fit 450mm stud centres)

R-Value	Nominal Thickness (mm)	Length (mm)	Width (mm)	Batts Per Pack	M ² Per Pack	Approx M ² Coverage
R1.5	75	1160	430	16	7.98	9.29
R2.0	75	1160	430	12	5.98	6.97
R2.0	90	1160	430	12	5.98	6.97
R2.5	90	1160	430	8	3.99	4.64

Standard R-Values, Sizes and Packaging (to fit 600mm stud centres)

R-Value	Nominal Thickness (mm)	Length (mm)	Width (mm)	Batts Per Pack	M ² Per Pack	Approx M ² Coverage
R1.5	75	1160	580	16	10.76	12.20
R2.0	75	1160	580	12	8.07	9.15
R2.0	90	1160	580	12	8.07	9.15
R2.5	90	1160	580	8	5.38i	6.10

Acoustic Performance

Tontine Thermal & Sound Batts are recommended for internal partition walls to reduce sound transmission. R_w is the weighted sound reduction index. It is a single number used to rate the effectiveness of a system as a noise insulator. An increase in one R_w of a given wall system will lead to a reduction of the noise level in the adjoining room by approximately 1 decibel. C_{tr} is a correction factor to R_w and puts more emphasis on low frequency noise transmission. Results are based on laboratory tests and acoustic opinions:

R _w RESULTS AND DETAILS			
R-Value	Cavity Thickness (A) mm	R _w	*NRC Value
R1.5	75	38	-
R2.0	75	38	.95
R2.0	90	40	.95
R2.5	90	40	1.00

*The sound absorption coefficient values are derived from reverberation room tests in accordance to AS ISO 354-2006.

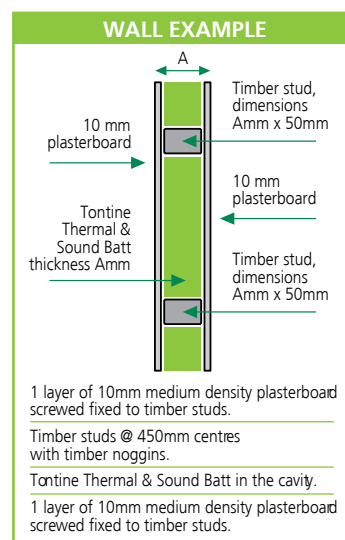



Thermal & Sound Batts

High Performance Residential Insulation



Fire Resistance

When tested in accordance with AS1530.3 (1999), "Early Fire Hazard Properties of Materials", the product exhibits the following characteristics:

Ignitability Index	0
Spread of Flame Index	0
Heat Evolved	0
Smoke Developed Index	0 – 3

Moisture Resistance

Exposure to an atmosphere of 50°C and 95% relative humidity for 4 days results in less than 0.2% by vol moisture absorption.

Maximum Service Temperature

The maximum service temperature to which Tontine Thermal & Sound Batts should be exposed in service is 150°C.

Environmental and Health Benefits

High Recycled Fibre Content	No Ammonia Content
No Harmful Volatile Organic Compounds (VOCs)	No Ozone Depleting Potential (ODP)
No Formaldehyde Content	No Chloride Content
No Phenol Content	100% Total Recyclable Content

How to Specify

The insulation material shall be Tontine Thermal & Sound Batts, R1.5 90mm; R2.0 75mm NRC .95; R2.0 90mm NRC .95; or R2.5 NRC 1.00 as manufactured by Tontine Insulation

General Installation Advice

Tontine Thermal and Sound Batts are safe and easy to install in walls. Batts are supplied in two widths to suit standard housing construction; 430mm widths for 450mm centres and 580mm for 600mm centres. Tontine Thermal and Sound Batts are easily torn or cut with a pair of industrial scissors or shears. Offcuts can be used to fill corners, crevices and gaps, eliminating any waste. The Batts are placed between the wall studs in a snug position before the plasterboard is put in place. If required, string/strap insulation into position (refer to AS3999). No special clothing, gloves or masks required for installation as the batts will not cause skin irritation. Allow up to one month for products subjected to compression packing to recover to their nominal thickness.



FOR FURTHER INFORMATION CALL 1300 467 852 OR EMAIL customer@tontineinsulation.com.au

Tontine Insulation is a division of Pacific NonWovens Pty. Ltd.

In most cases product testing has been conducted in laboratory situation under controlled conditions. Site-measured performance may vary due to installation quality and site conditions. Thermal testing has been carried out in accordance with AS/NZS 4859.1, and acoustic testing in accordance with ISO-354-2006 in certified reverberation rooms. As these products are subject to constant research and development, we reserve the right to update the contents without notice. Recommendations regarding the use of products are to be taken as a guide only, and the purchaser should independently determine the suitability of a product for the intended applications.

© Copyright 2008. ® and ™ are trademarks used by Tontine Insulation.

50 Bakers Rd Coburg North VIC 3058

Telephone: 1300 467 852

Fax: 1800 653 650

Email: customer@tontineinsulation.com.au

Website: www.tontineinsulation.com.au

Website: www.pnw.net.au

